

Name:		
Location:		
Email:		
Phone:	Cell:	
Fax:	Cover: HL13 HYBRID/KEDER	
Length:	Centers:	Arc: 120'-0"
Rafter Coating: ASTM-A123 Hot Dip Galvanized 3.9 mils Zinc		
Foundation:		

<b>100' PROFILE</b>	
<b>PRO-ADVANTAGE TRUSS</b>	
Notes:	

THIS DOCUMENT CONTAINS INFORMATION PROPRIETARY TO ACCU-STEEL INC. IT SHALL NOT BE REPRODUCED, USED, OR DISCLOSED WITHOUT PRIOR WRITTEN PERMISSION OF ACCU-STEEL INC.	
Date: 2/23/2012	
Project:	
Drawn By: JCB	
Sales #	



**1-877-338-6936**  
www.asicoverbuildings.com  
sales@asicoverbuildings.com

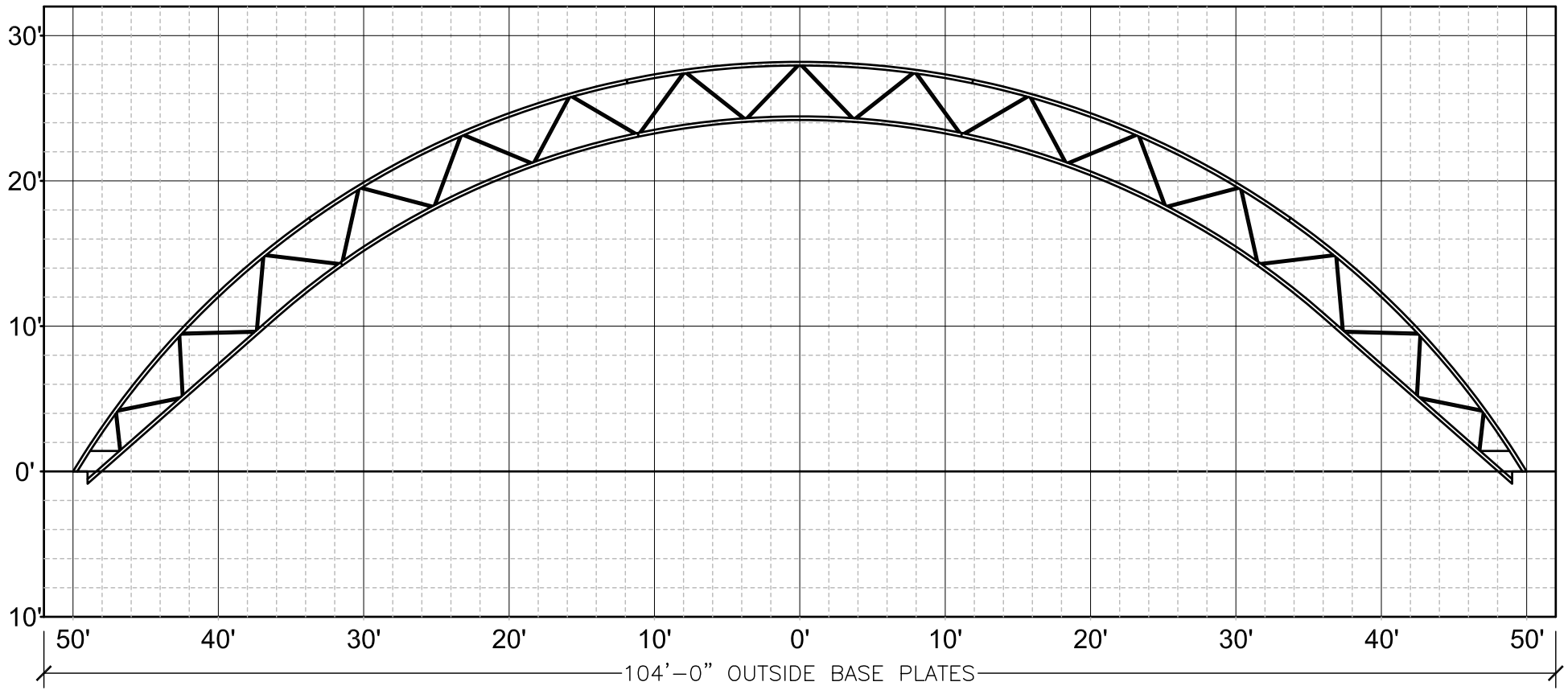

2'x2' GRID